

# Handling Guidelines for SKC Polypropylene Fitted Bags



skcinc.com

Form 38033 Rev 230213

- Do not overfill bags.

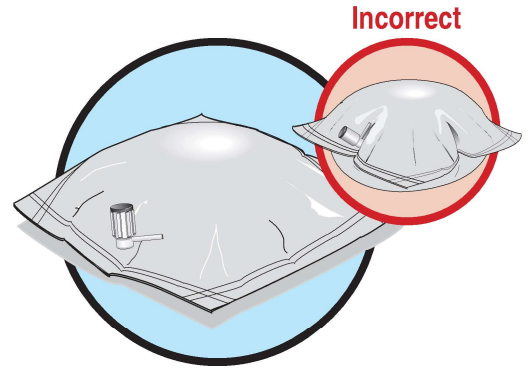

- Secure polypropylene valve when opening/closing by holding side stem while turning entire upper portion of fitting one revolution. *See how to properly open and close polypropylene fitting at <https://youtu.be/JTRTP-Vr7p8>.*



- Bags are designed for single use only.

